

NOTE: THIS DRAWING IS A COPYRIGHT. CONTENTS OF THE DRAWING OR PART THEREOF MAY NOT BE USED OR REPRODUCED WITHOUT THE PERMISSION OF M/S. ARCHTECH.

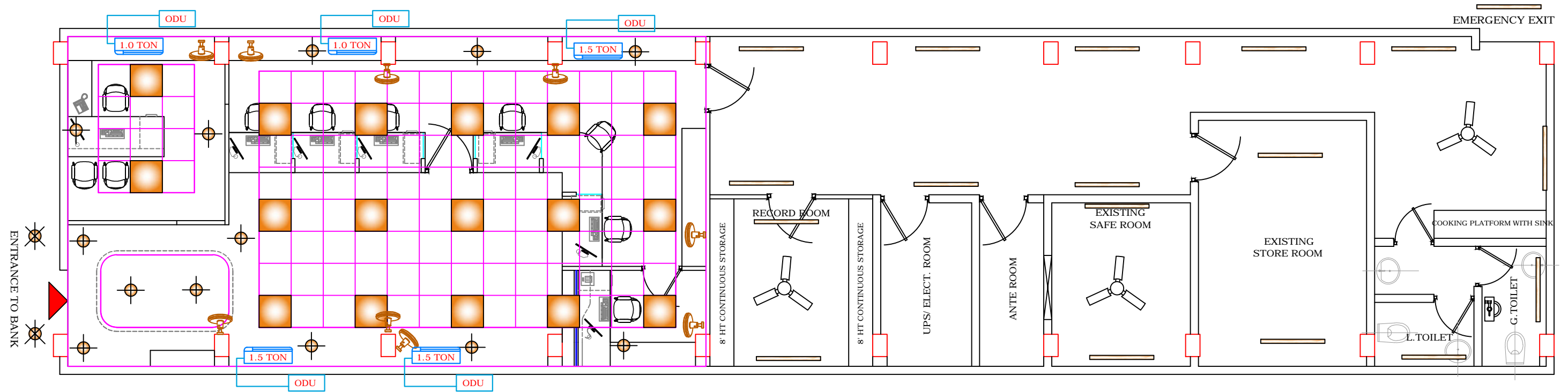

AC LAYOUT PLAN OF LAKHIPUR BRANCH (1ST FLOOR), LAKHIPUR, SILCHAR, ASSAM

AIR-CONDITIONING:	
1.0 TR	= 2 NOS
1.5 TR	= 3 NOS
2.0 TR	= 0 NOS
00 no. of AC point for ATM	
CASSETTE AC 2.0 TR = 0 NOS	
TOTAL AC = 6.5 TR OF 5 NOS	

**PROJECT
DETAIL**

PROPOSED FLOOR PLAN OF LAKHIPUR BRANCH
CLIENT: PUNJAB NATIONAL BANK, SILCHAR CIRCLE OFFICE
OPPO. VISHAL, CENTRAL ROAD, SILCHAR (ASSAM)
 DRAWING FOR REFERENCE DRAWING NO. 01

DIRECTION

Project dealt by:
 Ar. Awadhesh Shah
 Carpet area: 1803.6 SFT
 Date:- 22-12-2025

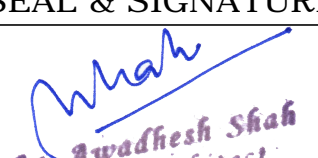
SEAL & SIGNATURE

 Ar. Awadhesh Shah
 Chief Architect
 M/s. Archtech
 Architects & Designers

FIRM'S NAME & ADDRESS
ArchTech
 Flat no. E2, Arun Enclave, Om Path,
 Opp. Sanskriti The Gurukul School,
 Ahom Gaon, Guwahati-781035
 Contact no.: +91-70052-05165
 Email ID: awadheshshah123@gmail.com

